

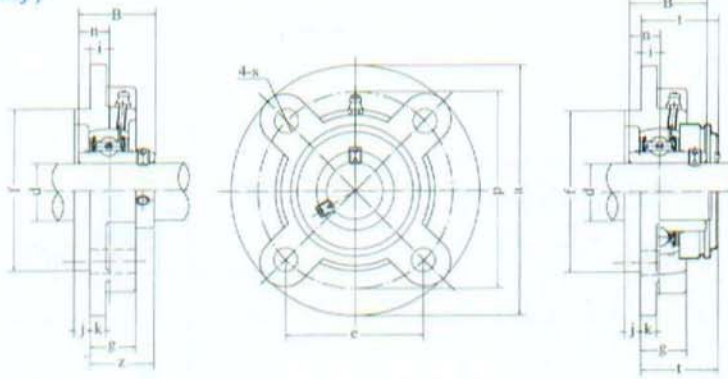

UCFC2 (Normal-duty)

Flange Cartridge Units



UCFC-C1(D1)

Table with columns: Unit No., Dimensions (mm/in), Bolt Size, Bearing No., Housing No., Weight (kg). Rows include units UCFC201 through UCFC218-56.

Flange Cartridge Units

HCFC 2 (Normal - duty)

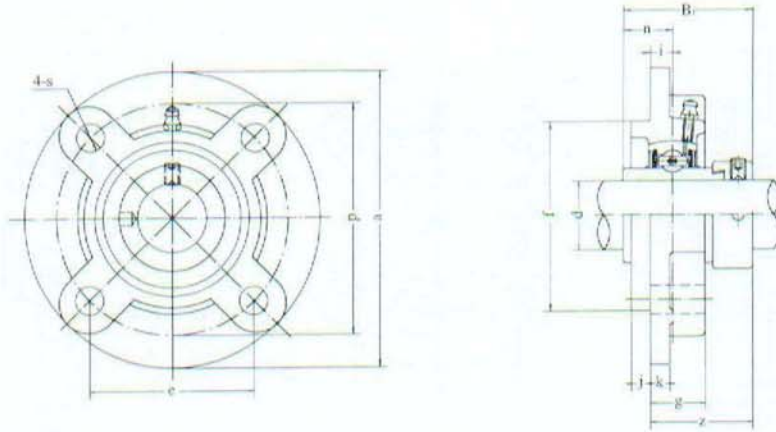

Unit No.	Dimensions ^{mm} _{in.}														Bolt Size ^{mm} _{inch}	Bearing No.	Housing No.	Weight (kg)
	d	a	p	e	j	s	l	k	g	f	z	B	n					
HCFC204	20	100	78	55.1	10	12	5	7	20.5	62	36.6	43.7	17.1	M10	HC204	FC204	0.76	
HCFC204-12	3/4	3-15/16	3-5/64	2-11/64	25/64	15/32	13/64	9/32	13/16	2.4409	1-7/16	1.720	0.673	3/8	HC204-12		0.76	
HCFC205	25	115	90	63.6	10	12	6	7	21	70	36.9	44.4	17.5	M10	HC205	FC205	1.07	
HCFC205-13	13/16														HC205-13		1.12	
HCFC205-14	7/8	4-17/32	3-35/64	2-1/2	25/64	15/32	15/64	9/32	53/64	2.7559	1-29/64	1.748	0.689	3/8	HC205-14		1.11	
HCFC205-15	15/16														HC205-15		1.09	
HCFC205-16	1														HC205-16		1.07	
HCFC206	30	125	100	70.7	10	12	8	8	23	80	40.1	48.4	18.3	M10	HC206	FC206	1.43	
HCFC206-17	1-1/16														HC206-17		1.48	
HCFC206-18	1-3/8	4-59/64	3-15/16	2-25/32	25/64	15/32	5/16	5/16	29/32	3.1496	1-37/64	1.906	0.720	3/8	HC206-18		1.45	
HCFC206-19	1-3/16														HC206-19		1.43	
HCFC206-20	1-1/4														HC206-20		1.40	
HCFC207	35	135	110	77.8	11	14	8	9	26	90	43.3	51.1	18.8	M12	HC207	FC207	1.93	
HCFC207-20	1-1/4														HC207-20		2.00	
HCFC207-21	1-5/16	1-5/16	4-21/64	3-1/16	7/16	35/64	5/16	23/64	1-1/32	3.5433	1-45/64	2.012	0.740	7/16	HC207-21		1.98	
HCFC207-22	1-3/8														HC207-22		1.93	
HCFC207-23	1-7/16														HC208-23		1.87	
HCFC208	40	145	120	84.8	11	14	10	9	26	100	45.9	56.3	21.4	M12	HC208	FC208	2.29	
HCFC208-24	1-1/2	5-45/64	4-23/32	3-11/32	7/16	35/64	25/64	23/64	1-1/32	3.9370	1-13/16	2.217	0.843	7/16	HC208-24		2.34	
HCFC208-25	1-9/16														HC208-25		2.30	
HCFC209	45	160	132	93.3	10	16	12	14	26	105	44.9	56.3	21.4	M14	HC209	FC209	2.85	
HCFC209-26	1-5/8														HC209-26		2.96	
HCFC209-27	1-11/16	6-19/64	5-13/64	3-43/64	25/64	5/8	15/32	35/64	1-1/32	4.1339	1-49/64	2.217	0.843	1/2	HC209-27		2.91	
HCFC209-28	1-3/4														HC209-28		2.87	
HCFC210	50	165	138	97.6	10	16	12	14	28	110	48.1	62.7	24.6	M14	HC210	FC210	3.09	
HCFC210-29	1-13/16														HC210-29		3.24	
HCFC210-30	1-7/8	6-1/2	5-7/16	3-27/32	25/64	5/8	15/32	35/64	1-7/64	4.3307	1-57/64	2.469	0.969	1/2	HC210-30		3.18	
HCFC210-31	1-15/16														HC210-31		3.12	
HCFC210-32	2														HC210-32		3.06	
HCFC211	55	185	150	106.1	13	19	12	15	31	125	56.6	71.4	27.8	M16	HC211	FC211	4.22	
HCFC211-32	2														HC211-32		4.42	
HCFC211-33	2-1/16	7-9/32	5-29/32	4-3/16	33/64	3/4	15/32	19/32	1-7/32	4.9213	2-15/64	2.811	1.094	5/8	HC211-33		4.34	
HCFC211-34	2-1/8														HC211-34		4.27	
HCFC211-35	2-3/16														HC211-35		4.19	
HCFC212	60	195	160	113.1	17	19	12	15	36	135	63.8	77.8	31	M16	HC212	FC212	5.28	
HCFC212-36	2-1/4														HC212-36		5.44	
HCFC212-37	2-5/16	7-11/16	6-19/64	4-29/64	43/64	3/4	15/32	19/32	1-27/64	5.3150	2-33/64	3.063	1.220	5/8	HC212-37		5.35	
HCFC212-38	2-3/8														HC212-38		5.30	
HCFC212-39	2-7/16														HC212-39		5.17	
HCFC213	65	205	170	120.2	16	19	14	15	36	145	67.6	85.7	34.1	M16	HC213	FC213	6.21	
HCFC213-40	2-1/2	8-5/64	6-11/16	4-47/64	5/8	3/4	35/64	19/32	1-27/64	5.5118	2-21/32	3.374	1.343	5/8	HC213-40		6.31	
HCFC213-41	2-9/16														HC213-41		6.20	
HCFC214	70	215	177	125.1	17	19	14	18	40	150	68.6	85.7	34.1	M16	HC214	FC214	7.45	
HCFC214-42	2-3/8														HC214-42		7.69	
HCFC214-43	2-11/16	8-15/32	6-31/32	4-59/64	43/64	3/4	35/64	23/32	1-37/64	5.9055	2-45/64	3.374	1.343	5/8	HC214-43		7.58	
HCFC214-44	2-3/4														HC214-44		7.46	
HCFC215	75	220	184	130.1	18	19	16	18	40	160	72.8	92.1	37.3	M16	HC215	FC215	8.19	
HCFC215-45	2-13/16														HC215-45		8.49	
HCFC215-46	2-7/8	8-21/32	7-1/4	5-1/8	23/32	3/4	5/8	23/32	1-37/64	6.2992	2-7/8	3.626	1.469	5/8	HC215-46		8.36	
HCFC215-47	2-15/16														HC215-47		8.23	
HCFC215-48	3														HC215-48		8.09	

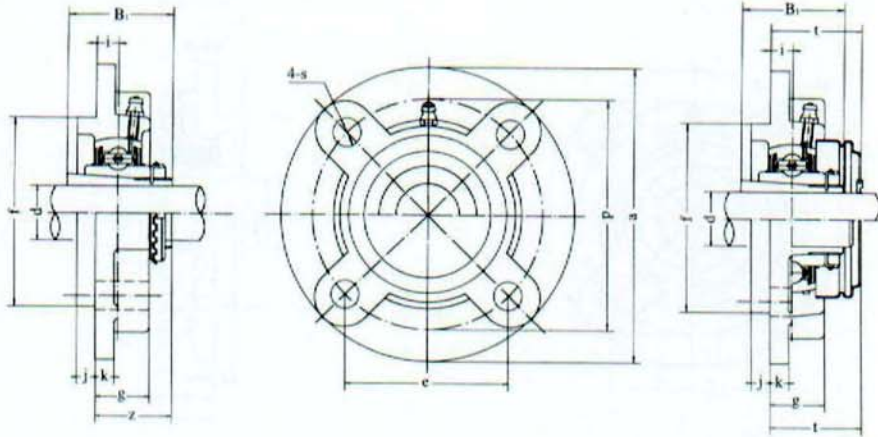

UCFC-C₁(D₁)

Unit No.	Dimensions														Bearing Size mm inch	Bearing No.	Housing No.	Weight (kg)
	d	a	p	e	i	s	j	k	g	f	z	t	B ₁					
UKFC205;H2305	20	115	90	63.6	10	12	6	7	21	70	29.5	34	35	M10	UK205;H2305	FC205	1.05	
UKFC205;HE2305	3/4	4-17/32	3-35/64	2-1/2	15/64	15/32	15/64	9/32	53/64	2.7559	1-5/32	1-11/32	1.378	3/8	UK205;HE2305			
UKFC206;H2306	25	125	100	70.7	10	12	8	8	23	80	31	36.5	38	M10	UK206;H2306	FC206	1.34	
UKFC206;HS2306	7/8	4-59/64	3-15/16	2-25/32	25/64	15/32	5/16	5/16	29/32	3.1496	1-7/32	1-7/16	1.496	3/8	UK206;HS2306			
UKFC206;HE2306	1														UK206;HE2306			
UKFC207;H2307	30	135	110	77.8	11	14	8	9	26	90	33.5	41	43	M12	UK207;H2307	FC207	1.90	
UKFC207;HS2307	1-1/8	5-5/16	4-21/64	3-1/16	7/16	35/64	5/16	23/64	1-1/32	3.5433	1-5/16	1-5/8	1.693	7/16	UK207;HS2307			
UKFC208;H2308	35	145	120	84.8	11	14	10	9	26	100	35.5	45.5	46	M12	UK208;H2308	FC208	2.24	
UKFC208;HE2308	1-1/4	5-45/64	4-23/32	3-11/32	7/16	35/64	25/64	23/64	1-1/32	3.9370	1-25/64	1-51/64	1.811	7/16	UK208;HE2308			
UKFC208;HS2308	1-3/8														UK208;HS2308			
UKFC209;H2309	40	160	132	93.3	10	16	12	14	26	105	36	44.5	50	M14	UK209;H2309	FC209	2.83	
UKFC209;HA2309	1-7/16														UK209;HA2309			
UKFC209;HE2309	1-1/2	6-19/64	5-13/64	3-43/64	25/64	5/8	15/32	35/64	1-1/32	4.1339	1-27/64	1-3/4	1.969	1-1/2	UK209;HE2309			
UKFC209;HS2309	1-5/8														UK209;HS2309			
UKFC210;H2310	45	165	138	97.6	10	16	12	14	28	110	37.5	47.5	55	M14	UK210;H2310	FC210	3.07	
UKFC210;HS2310	1-5/8														UK210;HS2310			
UKFC210;HA2310	1-11/16	6-1/2	5-7/16	3-27/32	25/64	5/8	15/32	35/64	1-7/64	4.3307	1-15/32	1-7/8	2.165	1/2	UK210;HA2310			
UKFC210;HE2310	1-3/4														UK210;HE2310			
UKFC211;H2311	50	185	150	106.1	13	19	12	15	31	125	41.5	51	59	M16	UK211;H2311	FC211	4.16	
UKFC211;HS2311	1-7/8														UK211;HS2311			
UKFC211;HA2311	1-15/16	7-9/32	5-29/32	4-3/16	33/64	3/4	15/32	19/32	1-7/32	4.9213	1-41/64	2-1/64	2.323	5/8	UK211;HA2311			
UKFC211;HE2311	2														UK211;HE2311			
UKFC212;H2312	55	195	160	113.1	17	19	12	15	36	135	48	61.5	62	M16	UK212;H2312	FC212	4.99	
UKFC212;HS2312	2-1/8	7-11/16	6-19/64	4-29/64	43/64	3/4	15/32	19/32	1-27/64	5.3150	1-57/64	2-27/64	2.441	5/8	UK212;HS2312			
UKFC213;H2313	60	205	170	120.2	16	19	14	15	36	145	49	60.5	65	M16	UK213;H2313	FC213	5.56	
UKFC213;HA2313	2-3/16														UK213;HA2313			
UKFC213;HE2313	2-1/4	8-5/64	6-11/16	4-47/64	5/8	3/4	35/64	19/32	1-27/64	5.5118	1-15/16	2-25/64	2.599	5/8	UK213;HE2313			
UKFC213;HS2313	2-3/8														UK213;HS2313			
UKFC215;H2315	65	220	184	130.1	18	19	16	18	40	160	53.5		73	M16	UK215;H2315	FC215	7.67	
UKFC215;HA2315	2-7/16	8-21/32	7-1/4	5-1/8	23/32	3/4	5/8	23/32	1-37/64	6.2992	2-7/64		2.874	5/8	UK215;HA2315			
UKFC215;HE2315	2-1/2														UK215;HE2315			
UKFC216;H2316	70	240	200	141.4	18	23	16	18	42	170	57		78	M20	UK216;H2316	FC216	9.41	
UKFC216;HA2316	2-11/16	9-29/64	7-7/8	5-9/16	23/32	29/32	5/8	23/32	1-21/32	6.6929	2-1/4		3.071	3/4	UK216;HA2316			
UKFC216;HE2316	2-3/4														UK216;HE2316			
UKFC217;H2317	75	250	208	147.1	18	23	18	20	45	180	59		82	M20	UK217;H2317	FC217	11.23	
UKFC217;HA2317	2-15/16	9-27/32	8-3/16	5-51/64	23/32	29/32	23/32	25/32	1-25/32	7.0866	2-21/64		3.228	3/4	UK217;HA2317			
UKFC217;HE2317	3														UK217;HE2317			
UKFC218;H2318	80	265	220	155.5	22	23	18	20	50	190	64.5		86	M20	UK218;H2318	FC218	13.34	
UKFC218;HA2318	3-3/16	10-7/16	8-21/32	6-1/8	55/64	29/32	23/32	25/32	1-31/32	7.4803	3-35/64		3.386	3/4	UK218;HA2318			

Flange Cartridge Units

UCFCX (medium-duty)

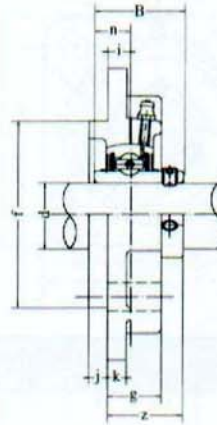
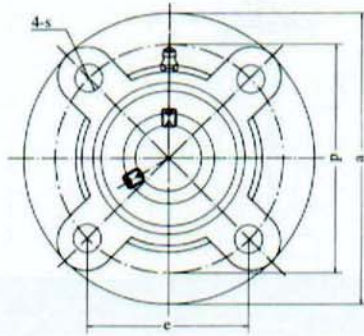

Unit No.	Dimensions ^{mm} _{in.}														Bolt Size _{mm} inch	Bearing No.	Housing No.	Weight (kg)
	d	a	p	e	i	s	j	k	g	f	z	B	n					
UCFCX05	25	111	92	65	10	9.5	6	9.5	24	76	32.2	38.1	15.9	M8	UCX05	FCX05	1.2	
UCFCX05-13	13/16														UCX05-13			
UCFCX05-14	7/8	4-3/8	3-5/8	2-9/16	25/64	3/8	15/64	3/8	15/16	2.9921	1-9/32	1.5000	0.626	5/16	UCX05-14			
UCFCX05-15	15/16														UCX05-15			
UCFCX05-16	1														UCX05-16			
UCFCX06	30	127	105	74.2	8	12	9.5	9.5	22.5	85	33.4	42.9	17.5	M10	UCX06	FCX06	1.5	
UCFCX06-17	1-1/16														UCX06-17			
UCFCX06-18	1-1/8	5	4-9/64	2-59/64	5/16	15/32	3/8	3/8	7/8	3.3465	1-5/16	1.6890	0.689	3/8	UCX06-18			
UCFCX06-19	1-3/16														UCX06-19			
UCFCX06-20	1-1/4														UCX06-20			
UCFCX07	35	133	111	78.5	9	12	11	11	26	92	39.2	49.2	19	M10	UCX07	FCX07	1.9	
UCFCX07-21	1-5/16														UCX07-21			
UCFCX07-22	1-3/8	5-1/4	4-3/8	3-3/32	23/64	15/32	7/16	7/16	1-1/32	3.6220	1-17/32	1.9370	0.748	3/8	UCX07-22			
UCFCX07-23	1-7/16														UCX07-23			
UCFCX08	40	133	111	78.5	9	12	11	11	26	92	39.2	49.2	19	M10	UCX08	FCX08	2.0	
UCFCX08-24	1-1/2														UCX08-24			
UCFCX08-25	1-9/16	5-1/4	4-3/8	3-3/32	23/64	15/32	7/16	7/16	1-1/32	3.6220	1-17/32	1.9370	0.748	3/8	UCX08-25			
UCFCX09	45	155	130	91.9	8	14	12	11	25	108	40.6	51.6	19	M12	UCX09	FCX09	2.6	
UCFCX09-26	1-5/8														UCX09-26			
UCFCX09-27	1-11/16	6-3/32	5-1/8	3-5/8	5/16	35/64	15/32	7/16	63/64	4.2520	1-19/32	2.0315	0.748	7/16	UCX09-27			
UCFCX09-28	1-3/4														UCX09-28			
UCFCX09-29	1-13/16														UCX09-29			
UCFCX10	50	162	136	96.2	7	14	16	11	25	118	40.4	55.6	22.2	M12	UCX10	FCX10	3.2	
UCFCX10-30	1-7/8														UCX10-30			
UCFCX10-31	1-15/16	6-3/8	5-23/64	3-25/32	9/32	35/64	5/8	7/16	83/64	4.6457	1-19/32	2.1890	0.874	7/16	UCX10-31			
UCFCX10-32	2														UCX10-32			
UCFCX11	55	180	152	107.5	4	16	22	13	26	127	43.7	65.1	25.4	M14	UCX11	FCX11	4.3	
UCFCX11-33	2-1/16														UCX11-33			
UCFCX11-34	2-1/8														UCX11-34			
UCFCX11-35	2-3/16	7-3/32	5-63/64	4-15/64	5/32	5/8	55/64	1/2	1-1/32	5.0000	1-23/32	2.5630	1.000	1/2	UCX11-35			
UCFCX11-36	2-1/4														UC211-36			
UCFCX11-37	2-5/16														UC211-37			
UCFCX12	60	194	165	116.7	11	16	20	14	33	140	50.7	65.1	25.4	M14	UCX12	FCX12	5.3	
UCFCX12-38	2-3/8	7-5/8	6-1/2	4-19/32	7/16	5/8	25/32	9/16	1-5/16	5.5118	2	2.5630	1.000	1/2	UCX12-38			
UCFCX12-39	2-7/16														UCX12-39			
UCFCX13	65	194	165	116.7	11	16	20	14	33	140	55.4	74.6	30.2	M14	UCX13	FCX13	5.7	
UCFCX13-40	2-1/2	7-5/8	6-1/2	4-19/32	7/16	5/8	25/32	9/16	1-5/16	5.5118	2-3/16	2.9370	1.189	1/2	UCX13-40			
UCFCX13-41	2-9/16														UCX13-41			
UCFCX14	70	222	190	134.3	14	19	20	14	36	164	58.5	77.8	33.3	M16	UCX14	FCX14	7.3	
UCFCX14-42	2-5/8														UCX14-42			
UCFCX14-43	2-1/16	8-3/4	7-31/64	5-9/32	35/64	3/4	25/32	9/16	1-13/32	6.4567	2-5/16	3.0630	1.311	5/8	UCX14-43			
UCFCX14-44	2-3/4														UCX14-44			
UCFCX15	75	222	190	134.3	12	19	22	16	35	164	61.3	82.6	33.3	M16	UCX15	FCX15	8	
UCFCX15-45	2-13/16														UCX15-45			
UCFCX15-46	2-7/8	8-3/4	7-31/64	5-9/32	15/32	3/4	55/64	5/8	1-3/8	6.4567	2-13/32	3.2520	1.311	5/8	UCX15-46			
UCFCX15-47	2-15/16														UCX15-47			
UCFCX15-48	3														UCX15-48			
UCFCX16	80	260	219	154.8	10	23	25	19	36	186	61.6	85.7	34.1	M20	UCX16	FCX16	11.3	
UCFCX16-49	3-1/16														UCX16-49			
UCFCX16-50	3-1/8	10-1/4	8-5/8	6-3/32	25/64	29/32	63/64	3/4	1-13/32	7.3228	2-7/16	3.3740	1.343	3/4	UCX16-50			
UCFCX16-51	3-3/16														UCX16-51			
UCFCX16-52	3-1/4														UCX16-52			
UCFCX17	85	260	219	154.8	10	23	25	19	36	186	66.3	96	39.7	M20	UCX17			FCX17
UCFCX17-53	3-5/16	10-1/4	8-5/8	6-3/32	25/64	29/32	63/64	3/4	1-13/32	7.3228	2-5/8	3.7795	1.5630	3/4	UCX17-53			
UCFCX17-55	3-7/16														UCX17-55			