

Flange Units (Square)

UCF2 (Normal-duty)

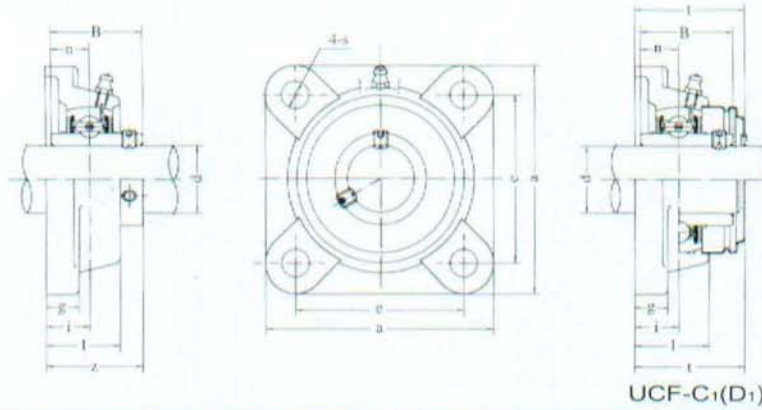

UCF-C<sub>1</sub>(D<sub>1</sub>)

Unit No.	Dimensions <small>mm in.</small>											Bolt Size <small>mm inch</small>	Bearing No.	Housing No.	Weight (kg)
	d	a	e	i	g	l	s	z	t	B	n				
UCF201	12	86	64	15	12	25.5	12	33.3	37.5	31	12.7	M10	UC201	F204	0.80
UCF201-8	1/2	3-3/8	2-33/64	19/32	15/32	1	15/32	1-5/16	1-31/64	1.2205	0.500	3/8	UC201-8		0.59
UCF202	15	86	64	15	12	25.5	12	33.3	37.5	31	12.7	M10	UC202	F204	0.59
UCF202-9	9/16	3-3/8	2-33/64	19/32	15/32	1	15/32	1-5/16	1-31/64	1.2205	0.500	3/8	UC202-9		0.59
UCF202-10	5/8												UC202-10		0.59
UCF203	17	86	64	15	12	25.5	12	33.3	37.5	31	12.7	M10	UC203	F204	0.58
UCF203-11	11/16	3-3/8	2-33/64	19/32	15/32	1	15/32	1-5/16	1-31/64	1.2205	0.500	3/8	UC203-11		0.57
UCF204	20	86	64	15	12	25.5	12	33.3	37.5	31	12.7	M10	UC204	F204	0.56
UCF204-12	3/4	3-3/8	2-33/64	19/32	15/32	1	15/32	1-5/16	1-31/64	1.2205	0.500	3/8	UC204-12		0.56
UCF205	25	95	70	16	14	27	12	35.8	40	34.1	14.3	M10	UC205	F205	0.80
UCF205-13	13/16												UC205-13		0.84
UCF205-14	7/8	3-3/4	2-3/4	5/8	35/64	1-1/16	15/32	1-13/32	1-9/16	1.3425	0.563	3/8	UC205-14		0.83
UCF205-15	15/16												UC205-15		0.81
UCF205-16	1												UC205-16		0.80
UCF206	30	108	83	18	14	31	12	40.2	44.5	38.1	15.9	M10	UC206	F206	1.12
UCF206-17	1-1/16												UC206-17		1.15
UCF206-18	1-1/8	4-1/4	3-17/64	45/64	35/64	1-7/32	15/32	1-19/32	1-3/4	1.5000	0.625	3/8	UC206-18		1.14
UCF206-19	1-3/16												UC206-19		1.12
UCF206-20	1-1/4												UC206-20		1.11
UCF207	35	117	92	19	16	34	14	44.4	48.5	42.9	17.5	M12	UC207	F207	1.46
UCF207-20	1-1/4												UC207-20		1.52
UCF207-21	1-5/16	4-39/64	3-5/8	3/4	5/8	1-11/32	35/64	1-3/4	1-29/32	1.6890	0.689	7/16	UC207-21		1.49
UCF207-22	1-3/8												UC207-22		1.46
UCF207-23	1-7/16												UC207-23		1.43
UCF208	40	130	102	21	16	36	16	51.2	55.5	49.2	19	M14	UC208	F208	1.84
UCF208-24	1-1/2	5-1/8	4-1/64	53/64	5/8	1-27/64	5/8	2-1/64	2-3/16	1.9370	0.748	1/2	UC208-24		1.88
UCF208-25	1-9/16												UC208-25		1.85
UCF209	45	137	105	22	18	38	16	52.2	56.5	49.2	19	M14	UC209	F209	2.15
UCF209-26	1-5/8	5-13/32	4-9/64	55/64	23/32	1-1/2	5/8	2-1/16	2-7/32	1.9370	0.748	1/2	UC209-26		2.25
UCF209-27	1-11/16												UC209-27		2.21
UCF209-28	1-3/4												UC209-28		2.17
UCF210	50	143	111	22	18	40	16	54.6	59.5	51.6	19	M14	UC210	F210	2.42
UCF210-29	1-13/16												UC210-29		2.54
UCF210-30	1-7/8	5-5/8	4-3/8	55/64	23/32	1-9/16	5/8	2-5/32	2-11/32	2.0315	0.748	1/2	UC210-30		2.49
UCF210-31	1-15/16												UC210-31		2.44
UCF210-32	2												UC210-32		2.40
UCF211	55	162	130	25	20	43	19	58.4	63	55.6	22.2	M16	UC211	F211	3.31
UCF211-32	2-1/16												UC211-32		3.46
UCF211-33	2-1/8	6-3/8	5-1/8	63/64	25/32	1-11/16	3/4	1-5/16	2-31/64	2.1890	0.874	5/8	UC211-33		3.40
UCF211-34	2-3/16												UC211-34		3.35
UCF211-35	2-3/8												UC211-35		3.29
UCF212	60	175	143	29	20	48	19	68.7	73.5	65.1	25.4	M16	UC212	F212	4.28
UCF212-36	2-1/4												UC212-36		4.41
UCF212-37	2-5/16	6-57/64	5-5/8	1-9/64	25/32	1-57/64	3/4	2-45/64	2-57/64	2.6630	1.000	5/8	UC212-37		4.33
UCF212-38	2-3/8												UC212-38		4.26
UCF212-39	2-7/16												UC212-39		4.19
UCF213	65	187	149	30	22	50	19	69.7	74.5	65.1	25.4	M16	UC213	F213	4.99
UCF213-40	2-1/2	7-23/64	5-55/64	1-3/16	55/64	1-31/32	3/4	2-3/4	2-15/16	2.5630	1.000	5/8	UC213-40		5.08
UCF213-41	2-9/16												UC213-41		4.99
UCF214	70	193	152	31	22	54	19	75.4	81.5	74.6	30.2	M16	UC214	F214	5.85
UCF214-42	2-5/8												UC214-42		6.06
UCF214-43	2-11/16	7-19/32	5-63/64	1-7/32	55/64	2-1/8	3/4	2-31/32	3-13/64	2.9370	1.189	5/8	UC214-43		5.96
UCF214-44	2-3/4												UC214-44		5.86
UCF215	75	200	159	34	22	56	19	78.5	83.5	77.8	33.3	M16	UC215	F215	6.91
UCF215-45	2-13/16												UC215-45		7.16
UCF215-46	2-7/8	7-7/8	6-17/64	1-11/32	55/64	2-7/32	3/4	3-3/32	3-9/32	3.0630	1.311	5/8	UC215-46		7.05
UCF215-47	2-15/16												UC215-47		6.94
UCF215-48	3												UC215-48		6.82
UCF216	80	208	165	34	22	58	23	83.3	88.5	82.6	33.3	M20	UC216	F216	7.50
UCF216-49	3-1/16												UC216-49		7.68
UCF216-50	3-1/8	8-3/16	6-1/2	1-11/32	55/64	2-9/32	29/32	3-9/32	3-31/64	3.2520	1.311	3/4	UC216-50		7.55
UCF216-51	3-3/16												UC216-51		7.42
UCF217	85	220	175	36	24	63	23	87.6	92.6	85.7	34.1	M20	UC217	F217	9.66
UCF217-52	3-1/4												UC217-52		9.88
UCF217-53	3-5/16	8-21/32	6-57/64	1-27/64	15/16	2-15/32	29/32	3-7/16	3-41/64	3.3740	1.343	3/4	UC217-53		9.74
UCF217-55	3-7/16												UC217-55		9.45
UCF218	90	235	187	40	24	68	23	96.3	101.5	96	39.7	M20	UC218	F218	12.06
UCF218-56	3-1/2	9-1/4	7-23/64	1-37/64	15/16	2-11/16	29/32	3-25/32	4	3.7795	1.5630	3/4	UC218-56		12.17

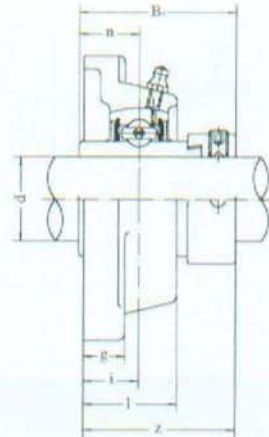
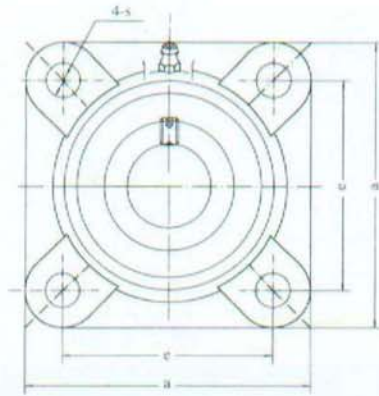

Unit No.	Dimensions <sup>mm</sup> <sub>in.</sub>										Bolt Size <sub>mm</sub> inch	Bearing No.	Housing No.	Weight (kg)
	d	a	e	l	g	S	z	B	n	u				
HCF204	20	86	64	15	12	25.5	12	41.6	43.7	17.1	M10	HC204	F204	0.63
HCF204-12	3/4	3-3/8	2-33/64	19/32	15/32	1	15/32	1-41/64	1.720	0.673	3/8	HC204-12		0.63
HCF205	25	95	70	16	14	27	12	42.9	44.4	17.5	M10	HC205	F205	0.87
HCF205-13	13/16											HC205-13		0.92
HCF205-14	7/8	3-3/4	2-3/4	5/8	35/64	1-1/16	15/32	1-11/16	1.748	0.889	3/8	HC205-14		0.91
HCF205-15	15/16											HC205-15		0.89
HCF205-16	1											HC205-16		0.87
HCF206	30	108	83	18	14	31	12	48.1	48.4	18.3	M10	HC206	F206	1.25
HCF206-17	1-1/16											HC206-17		1.30
HCF206-18	1-1/8	4-1/4	3-17/64	45/64	35/64	1-7/32	15/32	1-57/64	1.906	0.720	3/8	HC206-18		1.27
HCF206-19	1-3/16											HC206-19		1.25
HCF206-20	1-1/4											HC206-20		1.24
HCF207	35	117	92	19	16	34	14	51.3	51.1	18.8	M12	HC207	F207	1.58
HCF207-20	1-1/4											HC207-20		1.65
HCF207-21	1-5/16	4-39/64	3-5/8	3/4	5/8	1-11/32	35/64	2-1/64	2.012	0.740	7/16	HC207-21		1.61
HCF207-22	1-3/8											HC207-22		1.58
HCF207-23	1-7/16											HC207-23		1.55
HCF208	40	130	102	21	16	36	16	55.9	56.3	21.4	M14	HC208	F208	1.99
HCF208-24	1-1/2	5-1/8	4-1/64	53/64	5/8	1-27/32	5/8	2-13/64	2.217	0.843	1/2	HC208-24		2.04
HCF208-25	1-9/16											HC208-25		2.00
HCF209	45	137	105	22	18	38	16	56.9	56.3	21.4	M14	HC209	F209	2.32
HCF209-26	1-5/8											HC209-26		2.43
HCF209-27	1-11/16	5-13/32	4-9/64	55/64	55/64	1-1/2	5/8	2-15/64	2.217	0.843	1/2	HC209-27		2.38
HCF209-28	1-3/4											HC209-28		2.34
HCF210	50	143	111	22	18	40	16	60.1	62.7	24.6	M14	HC210	F210	2.61
HCF210-29	1-13/16											HC210-29		2.76
HCF210-30	1-7/8	5-5/8	4-3/8	55/64	23/32	1-9/16	5/8	2-3/8	2.469	0.969	1/2	HC210-30		2.70
HCF210-31	1-15/16											HC210-31		2.64
HCF210-32	2											HC210-32		2.58
HCF211	55	162	130	25	20	43	19	68.6	71.4	27.8	M16	HC211	F211	3.52
HCF211-32	2											HC211-32		3.72
HCF211-33	2-1/16	6-3/8	5-1/8	63/64	25/32	1-11/16	3/4	2-45/64	2.811	1.094	5/8	HC211-33		3.64
HCF211-34	2-1/8											HC211-34		3.57
HCF211-35	2-3/16											HC211-35		3.49
HCF212	60	175	143	29	20	48	19	75.8	77.8	31	M16	HC212	F212	4.82
HCF212-36	2-1/4											HC212-36		4.78
HCF212-37	2-5/16	6-57/64	5-5/8	1-9/64	25/32	1-57/64	3/4	2-63/64	3.063	1.220	5/8	HC212-37		4.69
HCF212-38	2-3/8											HC212-38		4.64
HCF212-39	2-7/16											HC212-39		4.51
HCF213	65	187	149	30	22	50	19	81.8	85.7	34.1	M16	HC213	F213	5.55
HCF213-40	2-1/2	7-23/64	5-65/64	1-3/16	55/64	1-31/32	3/4	3-7/32	3.374	1.343	5/8	HC213-40		5.65
HCF213-41	2-9/16											HC213-41		5.54
HCF214	70	193	152	31	22	54	19	82.6	85.7	34.1	M16	HC214	F214	6.35
HCF214-42	2-3/8											HC214-42		6.59
HCF214-43	2-11/16	7-19/32	5-63/64	1-7/32	55/64	2-1/8	3/4	3-1/4	3.374	1.343	5/8	HC214-43		6.48
HCF214-44	2-3/4											HC214-44		6.36
HCF215	75	200	159	34	22	56	19	88.8	92.1	37.3	M16	HC215	F215	7.54
HCF215-45	2-13/16											HC215-45		7.84
HCF215-46	2-7/8	7-7/8	6-17/64	1-11/32	55/64	2-7/32	3/4	3-1/2	3.626	1.426	5/8	HC215-46		7.71
HCF215-47	2-15/16											HC215-47		7.58
HCF215-48	3											HC215-48	7.44	



**Flange Units (square)**  
(with adapter mounted)

**UKF2 (Normal-duty)**

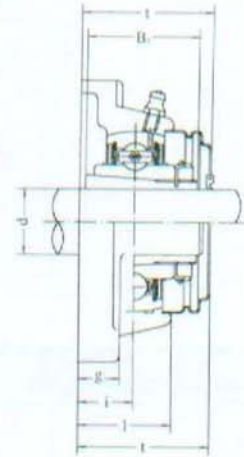
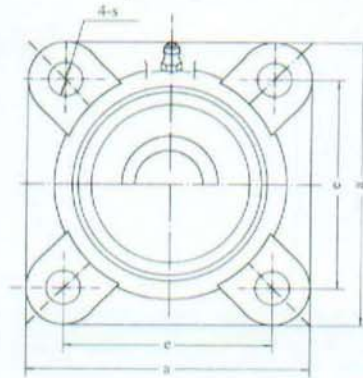
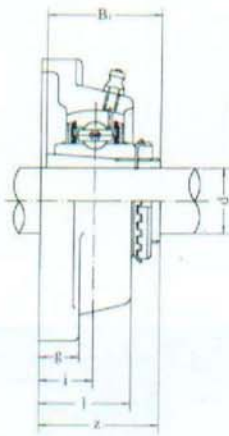

UKF-C<sub>1</sub>(D<sub>1</sub>)

Unit No.	Dimensions										Bearing Size mm inch	Bearing No.	Housing No.	Weight (kg)
	d	a	e	i	g	l	s	z	t	B <sub>1</sub>				
UKF205;H2305	20	95	70	16	14	27	12	35.5	40	35	M10	UK205;H2305	F205	0.85
UKF205;HE2305	3/4	3-3/4	2-3/4	5/8	35/64	1-1/16	15/32	1-25/64	1-9/16	1.378	3/8	UK205;HE2305		
UKF206;H2306	25	108	83	18	14	31	12	39	44.5	38	M10	UK206;H2306	F206	1.16
UKF206;HS2306	7/8	4-1/4	3-17/64	45/64	35/64	1-7/32	15/32	1-17/32	1-3/4	1.496	3/8	UK206;HS2306		
UKF206;HE2306	1											UK206;HE2306		
UKF207;H2307	30	117	92	19	16	34	14	42.5	48.5	43	M12	UK207;H2307	F207	1.55
UKF207;HS2307	1-1/8	4-39/64	3-5/8	3/4	5/8	1-11/32	35/64	1-43/64	1-29/32	1.693	7/16	UK207;HS2307		
UKF208;H2308	35	130	102	21	16	36	16	46.5	55.5	46	M14	UK208;H2308	F208	1.94
UKF208;HE2308	1-1/4	5-1/8	4-1/64	53/64	5/8	1-27/64	5/8	1-53/64	2-3/16	1.811	1/2	UK208;HE2308		
UKF208;HS2308	1-3/8											UK208;HS2308		
UKF209;H2309	40	137	105	22	18	38	16	48.5	56.5	50	M14	UK209;H2309	F209	2.30
UKF209;HA2309	1-7/16	5-13/32	4-9/64	55/64	23/32	1-1/2	5/8	1-29/32	2-7/32	1.969	1/2	UK209;HA2309		
UKF209;HE2309	1-1/2											UK209;HE2309		
UKF209;HS2309	1-5/8											UK209;HS2309		
UKF210;H2310	45	143	111	22	18	40	16	50	59.5	55	M14	UK210;H2310	F210	2.59
UKF210;HS2310	1-5/8	5-5/8	4-3/8	55/64	23/32	1-9/16	5/8	1-31/32	2-11/32	2.165	1/2	UK210;HS2310		
UKF210;HA2310	1-11/16											UK210;HA2310		
UKF210;HE2310	1-3/4											UK210;HE2310		
UKF211;H2311	50	162	130	25	20	43	19	54.5	63	59	M16	UK211;H2311	F211	3.46
UKF211;HS2311	1-7/8	6-3/8	5-1/8	63/64	25/32	1-11/16	3/4	2-9/64	2-31/64	2.323	5/8	UK211;HS2311		
UKF211;HA2311	1-15/16											UK211;HA2311		
UKF211;HE2311	2											UK211;HE2311		
UKF212;H2312	55	175	143	29	20	48	19	61	73.5	62	M16	UK212;H2312	F212	4.33
UKF212;HS2312	2-1/8	6-57/64	5-5/8	1-9/64	25/32	1-57/64	3/4	2-13/32	2-57/64	2.441	5/8	UK212;HS2312		
UKF213;H2313	60	187	149	30	22	50	19	64	74.5	65	M16	UK213;H2313	F213	4.90
UKF213;HA2313	2-3/16	7-23/64	5-55/64	1-3/16	55/64	1-31/32	3/4	2-33/64	2-15/16	2.559	5/8	UK213;HA2313		
UKF213;HE2313	2-1/4											UK213;HE2313		
UKF213;HS2313	2-3/8											UK213;HS2313		
UKF215;H2315	65	200	159	34	22	56	19	71	83.5	73	M16	UK215;H2315	F215	7.02
UKF215;HA2315	2-7/16	7-7/8	6-17/64	1-11/32	55/64	2-7/32	3/4	2-51/64	3-9/32	2.874	5/8	UK215;HA2315		
UKF215;HE2315	2-1/2											UK215;HE2315		
UKF216;H2316	70	208	165	34	22	58	23	73.5	88.5	78	M20	UK216;H2316	F216	7.76
UKF216;HA2316	2-11/16	8-3/16	6-1/2	1-11/32	55/64	2-9/32	29/32	2-57/64	3-31/64	3.071	3/4	UK216;HA2316		
UKF216;HE2316	2-3/4											UK216;HE2316		
UKF217;H2317	75	220	175	36	24	63	23	77	92.6	82	M20	UK217;H2317	F217	10.08
UKF217;HA2317	2-15/16	8-21/32	6-57/64	1-27/64	15/16	2-15/32	29/32	3-1/32	3-41/64	3.228	3/4	UK217;HA2317		
UKF217;HE2317	3											UK217;HE2317		
UKF218;H2318	80	235	187	40	24	68	23	81.5	101.5	86	M20	UK218;H2318	F218	12.44
UKF218;HA2318	3-3/16	9-1/4	7-23/64	1-37/64	15/16	2-11/16	29/32	3-13/64	4	3.386	3/4	UK218;HA2318		

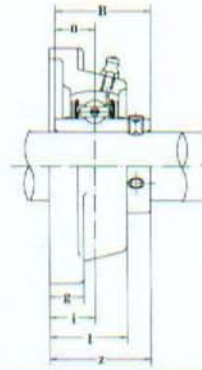
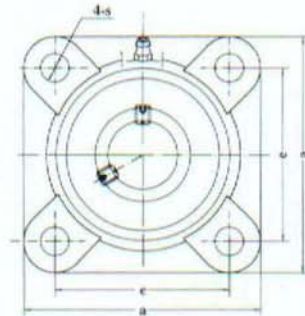

Unit No.	Dimensions mm in.										Bolt Size mm inch	Bearing No.	Housing No.	Weight (kg)
	d	a	e	l	g	l	s	z	B	n				
UCFX05	25	108	83	18	13	30	12	40.2	38.1	15.9	M10	UCX05	FX05	1.0
UCFX05-13	13/16											UCX05-13		
UCFX05-14	7/8	4-1/4	3-17/64	45/64	1/2	1-3/16	15/32	1-19/32	1.5000	0.626	3/8	UCX05-14		
UCFX05-15	15/16											UCX05-15		
UCFX05-16	1											UCX05-16		
UCFX06	30	117	92	19	14	34	16	44.4	42.9	17.5	M14	UCX06	FX06	1.7
UCFX06-17	1-1/16											UCX06-17		
UCFX06-18	1-1/8	4-39/64	3-5/8	3/4	9/16	1-11/32	5/8	1-3/4	1.6890	0.689	1/2	UCX06-18		
UCFX06-19	1-3/16											UCX06-19		
UCFX06-20	1-1/4											UCX06-20		
UCFX07	35	130	102	21	14	38	16	51.2	49.2	19	M14	UCX07	FX07	2.1
UCFX07-21	1-5/16											UCX07-21		
UCFX07-22	1-3/8	5-1/8	4-1/64	53/64	9/16	1-1/2	5/8	2-1/64	1.9370	0.748	1/2	UCX07-22		
UCFX07-23	1-7/16											UCX07-23		
UCFX08	40	137	105	22	14	40	19	52.2	49.2	19	M16	UCX08	FX08	2.4
UCFX08-24	1-1/2	5-13/32	4-9/64	55/64	9/16	1-9/16	3/4	2-1/64	1.9370	0.748	5/8	UCX08-24		
UCFX08-25	1-9/16											UCX08-25		
UCFX09	45	143	111	23	14	40	19	55.6	51.6	19	M16	UCX09	FX09	2.5
UCFX09-26	1-5/8											UCX09-26		
UCFX09-27	1-11/16	5-5/8	4-3/8	29/32	9/16	1-9/16	3/4	2-3/16	2.0315	0.748	5/8	UCX09-27		
UCFX09-28	1-3/4											UCX09-28		
UCFX09-29	1-13/16											UCX09-29		
UCFX10	50	162	130	26	20	44	19	59.4	55.6	22.2	M16	UCX10	FX10	3.9
UCFX10-30	1-7/8											UCX10-30		
UCFX10-31	1-15/16	6-3/8	5-1/8	1-1/32	25/32	1-23/32	3/4	2-11/32	2.1890	0.874	5/8	UCX10-31		
UCFX10-32	2											UCX10-32		
UCFX11	55	175	143	29	20	49	19	68.7	65.1	25.4	M16	UCX11	FX11	4.9
UCFX11-33	2-1/16											UCX11-33		
UCFX11-34	2-1/8	6-57/64	5-5/8	1-9/64	25/32	1-15/16	3/4	2-45/64	2.5630	1.000	5/8	UCX11-34		
UCFX11-35	2-3/16											UCX11-35		
UCFX11-36	2-1/4											UC211-36		
UCFX11-37	2-5/16											UC211-37		
UCFX12	60	187	149	34	21	59	19	73.7	65.1	25.4	M16	UCX12		
UCFX12-38	2-3/8	7-23/64	5-55/64	1-11/32	13/16	2-5/16	3/4	2-29/32	2.5630	1.000	5/8	UCX12-38		
UCFX12-39	2-7/16											UCX12-39		
UCFX13	65	187	149	34	21	59	19	78.4	74.6	30.2	M16	UCX13	FX13	5.3
UCFX13-40	2-1/2	7-23/64	5-55/64	1-11/32	13/16	2-5/16	3/4	3-3/32	2.9370	1.189	5/8	UCX13-40		
UCFX13-41	2-9/16											UCX13-41		
UCFX14	70	197	152	37	24	60	23	81.5	77.8	33.3	M20	UCX14	FX14	7.3
UCFX14-42	2-5/8											UCX14-42		
UCFX14-43	2-11/16	7-3/4	5-63/64	1-29/64	15/16	2-3/8	29/32	3-13/64	3.0630	1.311	3/4	UCX14-43		
UCFX14-44	2-3/4											UCX14-44		
UCFX15	75	197	152	40	24	68	23	89.3	82.6	33.3	M20	UCX15	FX15	8.1
UCFX15-45	2-13/16											UCX15-45		
UCFX15-46	2-7/8	7-3/4	5-63/64	1-37/64	15/16	2-11/16	29/32	3-33/64	3.2520	1.311	3/4	UCX15-46		
UCFX15-47	2-15/16											UCX15-47		
UCFX15-48	3											UCX15-48		
UCFX16	80	214	171	40	24	70	23	91.6	85.7	34.1	M20	UCX16	FX16	9.9
UCFX16-49	3-1/16											UCX16-49		
UCFX16-50	3-1/8	8-7/16	6-47/64	1-37/64	15/16	2-3/4	29/32	3-39/64	3.3740	1.343	3/4	UCX16-50		
UCFX16-51	3-3/16											UCX16-51		
UCFX16-52	3-1/4											UCX16-52		
UCFX17	85	214	171	40	24	70	23	96.3	96	39.7	M20	UCX17	FX17	11
UCFX17-53	3-5/16											UCX17-53		
UCFX17-55	3-7/16	8-7/16	6-47/64	1-37/64	15/16	2-3/4	29/32	3-25/32	3.7795	1.563	3/4	UCX17-55		
UCFX18	90	214	171	45	24	76	23	106.1	104	42.9	M20	UCX18	FX18	11
UCFX18-56	3-1/2	8-7/16	6-47/64	1-49/64	15/16	3	29/32	4-3/16	4.0945	1.689	3/4	UCX18-56		
UCFX20	100	268	211	59	31	97	31	127.3	117.5	49.2	M27	UCX20	FX20	17
UCFX20-64	4	10-9/16	8-5/16	2-21/64	1-7/32	3-13/16	1-7/32	5-1/64	4.6260	1.689	1	UCX20-64		



**Flange Units**(square)  
(with adapter mounted)

**UKFX** (Medium-duty)

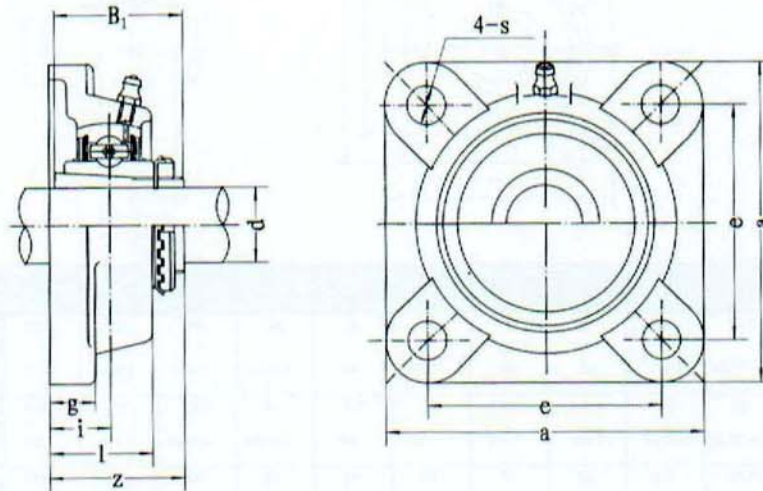

Unit No.	Dimensions <small>mm in.</small>									Bolt Used mm	Bearing NO.	Housing NO.	Weight (kg)
	d	a	e	i	g	s	z	B <sub>1</sub>					
UKFX05;H2305	20	108	83	18	13	30	12	39	35	M10	UKFX05;H2305	FX05	1.2
UKFX05;HE2305	3/4	4-1/4	3-17/64	45/64	1/2	1-3/16	15/32	1-17/32	1.378	3/8	UKFX05;HE2305		
UKFX06;H2306	25	117	92	19	14	34	16	41.5	38	M14	UKFX06;H2306	FX06	1.6
UKFX06;HS2306	7/8	4-39/64	3-5/8	3/4	9/16	1-11/32	5/8	1-41/64	1.496	1/2	UKFX06;HS2306		
UKFX06;HE2306	1										UKFX06;HE2306		
UKFX07;H2307	30	130	102	21	14	38	16	45.5	43	M14	UKFX07;H2307	FX07	2.0
UKFX07;HS2307	1-1/8	5-1/8	4-1/64	53/64	9/16	1-1/2	5/8	1-51/64	1.693	1/2	UKFX07;HS2307		
UKFX08;H2308	35	137	105	22	14	40	19	47.5	46	M16	UKFX08;H2308	FX08	2.3
UKFX08;HE2308	1-1/4	5-13/32	4-9/64	55/64	9/16	1-9/16	3/4	1-7/8	1.811	5/8	UKFX08;HE2308		
UKFX08;HS2308	1-3/8										UKFX08;HS2308		
UKFX09;H2309	40	143	111	23	14	40	19	50	50	M16	UKFX09;H2309	FX09	2.7
UKFX09;HA2309	1-5/8										UKFX09;HA2309		
UKFX09;HE2309	1-1/2	5-5/8	4-3/8	29/32	9/16	1-9/16	3/4	1-31/32	1.989	5/8	UKFX09;HE2309		
UKFX09;HS2309	1-5/8										UKFX09;HS2309		
UKFX10;H2310	45	162	130	26	20	44	19	55.5	55	M16	UKFX10;H2310	FX10	3.6
UKFX10;HS2310	1-5/8										UKFX10;HS2310		
UKFX10;HA2310	1-11/16	6-3/8	5-1/8	1-1/32	25/32	1-23/32	3/4	2-3/16	2.165	5/8	UKFX10;HA2310		
UKFX10;HE2310	1-3/4										UKFX10;HE2310		
UKFX11;H2311	50	175	143	29	20	49	19	60	59	M16	UKFX11;H2311	FX11	4.6
UKFX11;HS2311	1-7/8										UKFX11;HS2311		
UKFX11;HA2311	1-15/16	6-57/64	5-5/8	1-9/64	25/32	1-15/16	3/4	2-23/64	2.323	5/8	UKFX11;HA2311		
UKFX11;HE2311	2										UKFX11;HE2311		
UKFX12;H2312	55	187	149	34	21	59	19	67	62	M16	UKFX12;H2312	FX12	5.5
UKFX12;HS2312	2-1/8	7-23/64	5-55/64	1-11/32	13/16	2-5/16	3/4	2-41/64	2.441	5/8	UKFX12;HS2312		
UKFX13;H2313	60	187	149	34	21	59	19	68	65	M16	UKFX13;H2313	FX13	6.0
UKFX13;HA2313	2-3/16										UKFX13;HA2313		
UKFX13;HE2313	2-1/4	7-23/64	5-55/64	1-11/32	13/16	22-5/16	3/4	2-11/16	2.559	5/8	UKFX13;HE2313		
UKFX13;HS2313	2-3/8										UKFX13;HS2313		
UKFX15;H2315	65	197	152	40	24	68	23	77.5	73	M20	UKFX15;H2315	FX15	8.1
UKFX15;HA2315	2-7/16	7-3/4	5-63/64	1-37/64	15/16	2-11/16	29/32	2-3/64	2.674	3/4	UKFX15;HA2315		
UKFX15;HS2315	2-1/2										UKFX15;HS2315		
UKFX16;H2316	70	214	171	40	24	70	23	80	78	M20	UKFX16;H2316	FX16	9.5
UKFX16;HA2316	2-11/16	8-7/16	6-47/64	1-37/64	15/16	2-3/4	29/32	3-5/32	3.071	3/4	UKFX16;HA2316		
UKFX16;HS2316	2-3/4										UKFX16;HS2316		
UKFX17;H2317	75	214	171	40	24	70	23	81.5	82	M20	UKFX17;H2317	FX17	10.4
UKFX17;HA2317	2-15/16	8-7/16	6-47/64	15/16	2-3/4	29/32	3-13/64	3.228	3/4		UKFX17;HA2317		
UKFX17;HE2317	3										UKFX17;HE2317		
UKFX18;H2318	80	214	171	45	24	76	23	88	86	M20	UKFX18;H2318	FX18	11.4
UKFX18;HA2318	3-3/16	8-7/16	6-47/64	1-49/64	15/16	3	29/32	3-15/32	3.386	3/4	UKFX18;HA2318		
UKFX20;H2320	90	268	211	59	31	97	31	106	97	M27	UKFX20;H2320	FX19	18.4
UKFX20;HA2320	3-1/2	10-9/16	8-5/16	2-21/64	1-7/32	3-13/13	1-7/32	4-3/64	3.814	1	UKFX20;HA2320		



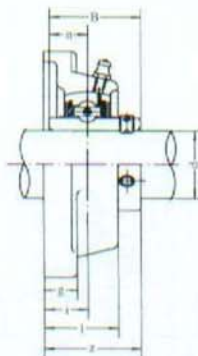
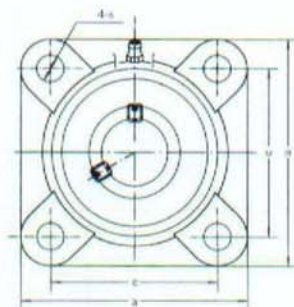

Unit No.	Dimensions										Bolt Size mm inch	Bearing No.	Housing No.	Weight (kg)
	d	a	e	g	l	s	z	B	n	inch				
UCF305 UCF305-13 UCF305-14 UCF305-15 UCF305-16	25 13/16 7/8 15/16 1	110	80	16	13	29	16	39	38	15	M14	UC305 UC305-13 UC305-14 UC305-15	F305	1.1
UCF306 UCF306-17 UCF306-18 UCF306-19	30 1-1/16 1-1/8 1-3/16	125	95	18	15	32	16	44	43	17	M14	UC306-16 UC306 UC306-17 UC306-18 UC306-19	F306	1.6
UCF307 UCF307-20 UCF307-21 UCF307-22 UCF307-23	35 1-1/4 1-5/16 1-3/8 1-7/16	135	100	20	16	36	19	49	48	19	M16	UC307 UC307-20 UC307-21 UC307-22 UC307-23	F307	2
UCF308 UCF308-24 UCF308-25	40 1-1/2 1-9/16	150	112	23	17	40	19	56	52	19	M16	UC308 UC308-24 UC308-25	F308	2.7
UCF309 UCF309-26 UCF309-27 UCF309-28	45 1-5/8 1-11/16 1-3/4	160	125	25	18	44	19	60	57	22	M16	UC309 UC309-26 UC309-27 UC309-28	F309	3.4
UCF310 UCF310-29 UCF310-30 UCF310-31	50 1-13/16 1-7/8 1-15/16	175	132	28	19	48	23	67	61	22	M20	UC310 UC310-29 UC310-30 UC310-31	F310	4.5
UCF311 UCF311-32 UCF311-33 UCF311-34 UCF311-35	55 2 2-1/16 2-1/8 2-3/16	185	140	30	20	52	23	71	66	25	M20	UC311 UC311-32 UC311-33 UC311-34 UC311-35	F311	5.5
UCF312 UCF312-36 UCF312-37 UCF312-38 UCF312-39	60 2-1/4 2-5/16 2-3/8 2-7/16	195	150	33	22	56	23	78	71	26	M20	UC312 UC312-36 UC312-37 UC312-38 UC312-39	F312	6.5
UCF313 UCF313-40 UCF313-41	65 2-1/2 2-9/16	208	166	33	22	58	23	78	75	30	M20	UC313 UC313-40 UC313-41	F313	7.9
UCF314 UCF314-42 UCF314-43 UCF314-44	70 2-5/8 2-11/16 2-3/4	226	178	36	25	61	25	81	78	33	M22	UC314 UC314-42 UC314-43 UC314-44	F314	9.5
UCF315 UCF315-45 UCF315-46 UCF315-47 UCF315-48	75 2-13/16 2-7/8 2-15/16 3	236	184	39	25	66	25	89	82	32	M22	UC315 UC315-45 UC315-46 UC315-47 UC315-48	F315	12
UCF316 UCF316-49 UCF316-50 UCF316-51	80 3-1/16 3-1/8 3-3/16	250	196	38	27	68	31	90	86	34	M27	UC316 UC316-49 UC316-50 UC316-51	F316	14
UCF317 UCF317-52 UCF317-53 UCF317-55	85 3-1/4 3-5/16 3-7/16	260	204	44	27	74	31	100	96	40	M27	UC317 UC317-52 UC317-53 UC317-55	F317	18
UCF318 UCF318-55 UCF318-56	90 3-7/16 3-1/2	280	216	44	30	76	35	100	96	40	M30	UC318 UC318-55 UC318-56	F318	19
UCF319 UCF319-58 UCF319-59 UCF319-60	95 3-5/8 3-11/16 3-3/4	290	228	59	30	94	35	121	103	41	M30	UC319 UC319-58 UC319-59 UC319-60	F319	22
UCF320 UCF320-64	100 4	310	242	59	32	94	38	125	108	42	M33	UC320 UC320-64	F320	26
UCF322	110	340	266	60	35	96	41	131	117	46	M36	UC322	F322	38
UCF324	120	370	290	65	40	110	41	140	126	51	M36	UC324	F324	50
UCF326	130	410	320	65	45	115	41	146	135	54	M36	UC326	F326	66
UCF328	140	450	350	75	55	125	41	161	145	59	M36	UC328	F328	90



**Flange Units (square)**  
(with adapter mounted)

**UKF3 (Heavy-duty)**

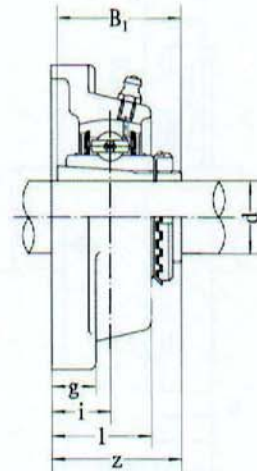
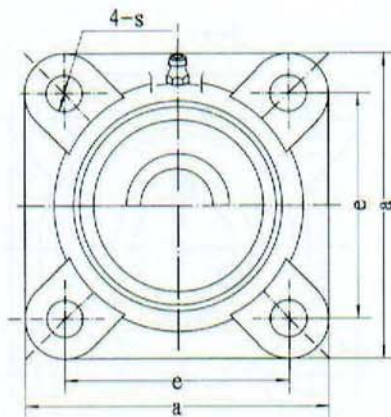

Unit No.	Dimensions mm in.									Bolt Size mm inch	Bearing No.	Housing No.	Weight (kg)
	d	a	e	i	g	l	s	z	B <sub>1</sub>				
UKF305;H2305	20	110	80	16	13	29	16	37	35	M14	UK305;H2305	F305	1.4
UKF305;HE2305	3/4	4-11/32	3-5/32	5/8	1/2	1-5/32	5/8	1-29/64	1.378	1/2	UK305;HE2305		
UKF306;H2306	25	125	95	18	15	32	16	40.5	38	M14	UK306;H2306	F306	1.9
UKF306;HS2306	7/8	4-29/32	3-47/64	45/64	19/32	1-1/4	5/8	2-19/32	1.496	1/2	UK306;HS2306		
UKF306;HE2306	1										UK306;HE2306		
UKF307;H2307	30	135	100	20	16	36	19	44.5	43	M16	UK307;H2307	F307	2.3
UKF307;HS2307	1-1/8	5-5/16	3-15/16	25/32	5/8	1-13/32	3/4	2-3/4	1.693	5/8	UK307;HS2307		
UKF308;H2308	35	150	112	23	17	40	19	50	46	M16	UK308;H2308	F308	3.1
UKF308;HE2308	1-1/4	5-29/32	4-13/32	29/32	21/32	1-9/16	3/4	2-31/32	1.811	5/8	UK308;HE2308		
UKF308;HS2308	1-3/8										UK308;HS2308		
UKF309;H2309	40	160	125	25	18	44	19	54.5	50	M16	UK309;H2309	F309	4.1
UKF309;HA2309	1-7/16										UK309;HA2309		
UKF309;HE2309	1-1/2	6-6/16	4-59/64	63/64	23/32	1-23/32	3/4	2-9/64	1.969	M16	UK309;HE2309		
UKF309;HS2309	1-5/8										UK309;HS2309		
UKF310;H2310	45	175	132	28	19	48	23	60	55	M20	UK310;H2310	F310	5.1
UKF310;HS2310	1-7/8										UK310;HS2310		
UKF310;HA2310	1-11/16	6-7/8	5-13/64	1-7/64	3/4	1-7/8	29/32	2-23/64	2.165	3/4	UK310;HA2310		
UKF310;HE2310	1-3/4										UK310;HE2310		
UKF311;H2311	50	185	140	30	20	52	23	63.5	59	M20	UK311;H2311	P311	5.9
UKF311;HS2311	1-7/8										UK311;HS2311		
UKF311;HA2311	1-15/16	7-9/32	5-33/64	1-3/16	25/32	2-1/16	29/32	2-1/2	2.323	3/4	UK311;HA2311		
UKF311;HE2311	2										UK311;HE2311		
UKF312;H2312	55	195	150	33	22	56	23	69	62	M20	UK312;H2312	F312	6.8
UKF312;HS2312	2-1/8	7-11/16	5-29/32	1-19/64	7/8	2-7/32	29/32	2-23/32	2.441	3/4	UK312;HS2312		
UKF313;H2313	60	208	166	33	22	58	23	71	65	M20	UK313;H2313	F313	7.9
UKF313;HA2313	2-3/16										UK313;HA2313		
UKF313;HS2313	2-1/4	8-3/16	6-17/32	1-19/64	7/8	2-9/32	29/32	2-51/64	2.559	3/4	UK313;HS2313		
UKF313;HE2313	2-3/8										UK313;HE2313		
UKF315;H2315	65	236	184	39	25	66	25	81	73	M22	UK315;H2315	F315	11.7
UKF315;HA2315	2-7/16										UK315;HA2315		
UKF315;HE2315	2-1/2	9-9/32	7-1/4	1-17/32	63/64	2-19/32	63/64	3-3/16	2.874	7/8	UK315;HE2315		
UKF316;H2316	70	250	196	38	27	68	31	83.5	78	M27	UK316;H2316	F316	12.9
UKF316;HA2316	2-11/16										UK316;HA2316		
UKF316;HE2316	2-3/4	9-27/32	7-23/32	1-1/2	1-1/16	2-11/16	1-7/32	3-9/32	3.071	1	UK316;HE2316		
UKF317;H2317	75	260	204	44	27	74	31	92	82	M27	UK317;H2317	F317	15.2
UKF317;HA2317	2-15/16										UK317;HA2317		
UKF317;HS2317	3	10-1/4	8-1/32	1-47/64	1-1/16	2-29/32	3-5/8	3.228	1		UK317;HS2317		
UKF318;H2318	80	280	216	44	30	76	35	93.5	86	M30	UK318;H2318	F318	19.0
UKF318;HA2318	3-1/16	11-1/32	8-1/2	1-47/64	1-3/16	3	1-3/8	3-11/16	3.386	1-1/8	UK318;HA2318		
UKF319;H2319	85	290	228	59	30	94	35	111	90	M30	UK319;H2319	F319	21.9
UKF319;HA2319	3-5/16	11-13/32	8-31/32	2-21/64	1-3/16	3-11/16	1-3/8	4-3/8	3.543	1-1/8	UK319;HA2319		
UKF320;H2320	90	310	242	59	32	94	38	115	97	M33	UK320;H2320	F320	25.4
UKF320;HA2320	3-7/16	12-7/32	9-17/32	2-21/64	1-1/4	3-11/16	1-1/2	4-17/32	3.814	1-1/4	UK320;HA2320		
UKF322;H2322	100	340	266	60	35	96	41	121	105	M36	UK322;H2322	F322	35.2
UKF322;HA2322	3-15/16	13-3/8	10-15/32	3-23/64	1-3/8	3-25/32	1-39/64	4-49/64	4.134	1-3/8	UK322;HA2322		
UKF324;H2324	110	370	290	65	40	110	41	130	112	M36	UK324;H2324	F324	47.6
UKF324;HA2324	4-3/16	16-5/32	12-19/32	2-9/16	1-9/16	4-11/32	1-39/64	5-1/8	4.410	1-3/8	UK324;HA2324		
UKF326;H2326	115	410	320	65	45	115	41	134	121	M36	UK326;H2326	F326	65.3
UKF326;HA2326	4-7/16	16-5/32	12-19/32	2-9/64	1-25/32	4-17/32	1-39/64	5-9/32	4.764	1-3/8	UK326;HA2326		
UKF328;H2328	125	450	350	75	55	125	41	148	131	M36	UK328;H2328	F328	93.4
UKF328;HA2328	4-15/16	17-23/32	13-25/32	2-61/64	2-5/32	4-29/32	1-39/64	5-53/64	5.158	1-3/8	UK328;HA2328		



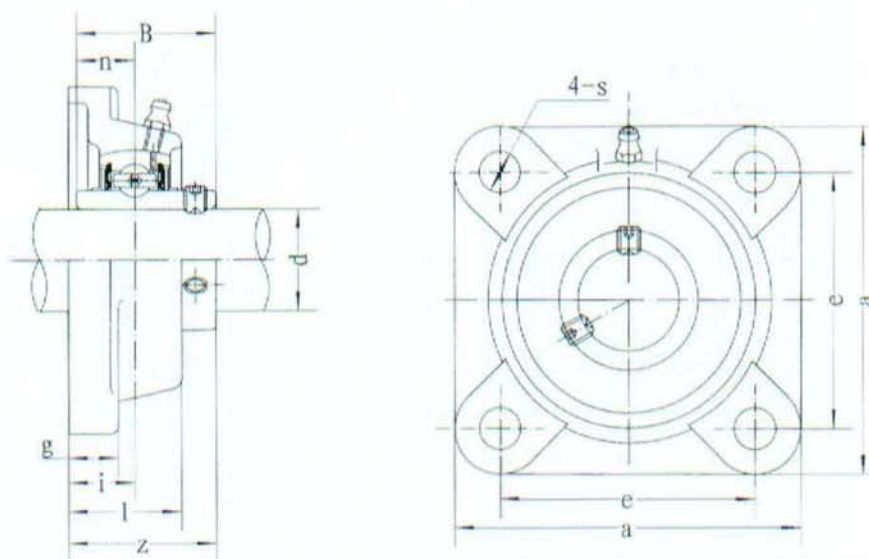

Unit No.	Dimensions <sup>mm</sup> <sub>in.</sub>										Bolt Size mm inch	Bearing No.	Housing No.	Weight (kg)
	d	a	e	i	g	l	s	z	B	n				
UCSFU203	17	76	54	15	11	25.5	12	30.9	27.4	11.5	M10	UCS203	FU203	0.39
UCFU203	17	86	63.5	19	15	29.5	12	37.3	31	12.7	M10	UC203	FU204	0.65
UCFU203-11	11/16											UC203-11		
UCFU204	20	3-3/8	2-1/2	3/4	19/32	1-5/32	15/32	1-15/32	1.2205	0.500	3/8	UC204	FU204	0.63
UCFU204-12	3/4											UC204-11		
UCFU205	25	93	70	19	15	30	12	38.8	34.1	14.3	M10	UC205	FU205	0.75
UCFU205-13	13/16	3-21/32	2-3/4	3/4	19/32	1-3/16	15/32	1-17/32	1.3425	0.563	3/8	UC205-13		
UCFU205-14	7/8											UC205-14		
UCFU205-15	15/16											UC205-15		
UCFU205-16	1											UC205-16		
UCFU206	30											106	82.5	20
UCFU206-17	1-1/16	4-11/64	3-1/4	25/32	5/8	1-9/32	15/32	1-21/32	1.5000	0.626	3/8	UC206-17	FU206	1.09
UCFU206-18	1-1/8											UC206-18		
UCFU206-19	1-3/16											UC206-19		
UCFU206-20	1-1/4											UC206-20		
UCFU207	35											116		
UCFU207-20	1-1/4	4-9/16	3-5/8	53/64	43/64	1-3/8	35/64	1-53/64	1.0890	0.689	7/16	UC207-20	FU207	1.36
UCFU207-21	1-5/16											UC207-21		
UCFU207-22	1-3/8											UC207-22		
UCFU207-23	1-7/16											UC207-23		
UCFU208	40											129		
UCFU208-24	1-1/2	5-5/64	4	15/16	43/64	1-17/32	64/35	2-1/8	1.9376	0.748	7/16	UC208-24	FU208	1.81
UCFU208-25	1-9/16											UC208-25		
UCFU209	45	135	105	24	18	40	16	54.2	49.2	19	M14	UC209	FU209	2.15
UCFU209-26	1-5/8	5-5/16	4-9/64	15/16	23/32	1-37/64	5/8	2-1/8	1.9370	0.748	1/2	UC209-26		
UCFU209-27	1-11/16											UC209-27		
UCFU209-28	1-3/4											UC209-28		
UCFU210	50											143	111	28
UCFU210-29	1-13/16	5-5/8	4-3/8	1-3/32	25/32	1-49/64	23/32	2-25/64	2.0315	0.748	1/2	UC210-29	FU210	2.51
UCFU210-30	1-7/8											UC210-30		
UCFU210-31	1-15/16											UC210-31		
UCFU210-32	2											UC210-32		
UCFU211	55	162	130	31	21	49	18	64.4	55.6	22.2	M16	UC211	FU211	3.42
UCFU211-32	2	6-3/8	5-1/8	1-7/32	53/64	1-59/64	23/32	2-17/32	2.1890	0.874	5/8	UC211-32		
UCFU211-33	2-1/16											UC211-33		
UCFU211-34	2-1/8											UC211-34		
UCFU211-35	2-3/16											UC211-35		
UCFU212	60											175	143	34
UCFU212-36	2-1/4	6-37/64	5-5/8	1-11/32	55/64	1-7/64	23/32	2-29/32	2.5630	1.000	5/8	UC212-36	FU212	4.26
UCFU212-37	2-5/16											UC212-37		
UCFU212-38	2-3/8											UC212-38		
UCFU212-39	2-7/16											UC212-39		
UCFU213	65											184		
UCFU213-40	2-1/2	7-1/4	5-55/64	1-1/2	55/64	2-9/32	23/32	3-1/16	2.5630	1.000	5/8	UC213-40	FU213	5.44
UCFU213-41	2-9/12											UC213-41		
UCFU214	70	188	152	38	23	59	18	82.4	74.6	19	M16	UC214	FU214	6.00
UCFU214-42	1-5/8	5-5/16	4-9/64	15/16	23/32	1-37/64	5/8	2-1/8	1.9370	0.748	5/8	UC214-42		
UCFU214-43	1-11/16											UC214-43		
UCFU214-44	1-3/4											UC214-44		
UCFU215	75											200	159	41
UCFU215-45	2-13/16	7-7/8	6-17/64	1-39/64	15/16	2-7/16	23/32	3-23/64	3.0630	1.311	5/8	UC215-45	FU215	6.83
UCFU215-46	2-7/8											UC215-46		
UCFU215-47	2-15/16											UC215-47		
UCFU215-48	3											UC215-48		



Flange Units (square)

HCFU2 (Normal-duty)

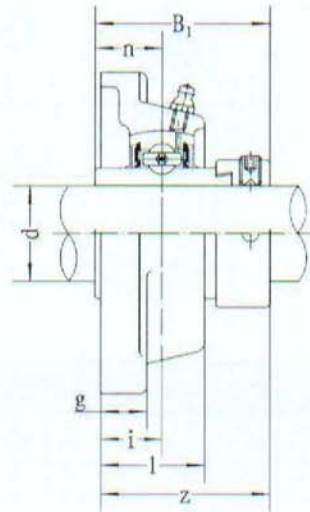
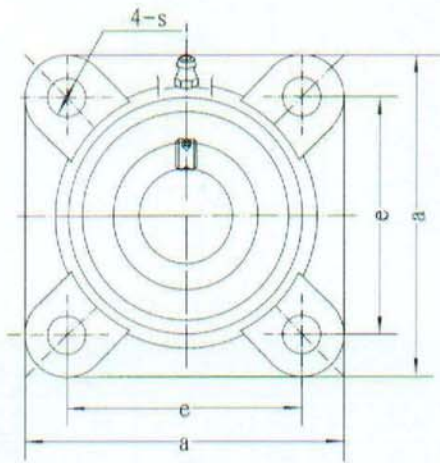

Unit No.	Dimensions <sup>mm</sup> <sub>in.</sub>										Bolt Size <sub>mm</sub> inch	Bearing No.	Housing No.	Weight (kg)	
	d	a	e	l	g	l	s	z	B <sub>1</sub>	n					
HCFU203	17												HC203	FU204	0.70
HCFU203-11	11/16	86	63.5	19	15	29.5	12	45.6	43.7	17.1	M10	HC203-11	FU204	0.70	
HCFU204	20	3-3/8	2-1/2	3/4	19/32	1-5/32	15/32	1-51/64	1.720	0.673	3/8	HC204	FU204	0.68	
HCFU204-12	3/4											HC204-12	FU204	0.68	
HCFU205	25	93	70	19	15	30	12	45.9	44.1	17.5	M10	HC205	FU205	0.81	
HCFU205-13	13/16											HC205-13	FU205	0.81	
HCFU205-14	7/8	3-21/32	2-3/4	3/4	19/32	1-3/16	15/32	1-13/16	1.748	0.689	3/8	HC205-14	FU205	0.81	
HCFU205-15	15/16											HC205-15	FU205	0.81	
HCFU205-16	1											HC205-16	FU205	0.81	
HCFU206	30	106	82.5	20	16	32.5	12	50.1	48.4	18.3	M10	HC206	FU206	1.16	
HCFU206-17	1-1/16											HC206-17	FU206	1.16	
HCFU206-18	1-1/8	4-11/64	3-1/4	25/32	5/8	1-9/32	15/32	1-31/32	1.906	0.720	3/8	HC206-18	FU206	1.16	
HCFU206-19	1-3/16											HC206-19	FU206	1.16	
HCFU206-20	1-1/4											HC206-20	FU206	1.16	
HCFU207	35	116	92	21	17	35	14	53.3	51.1	18.8	M12	HC207	FU207	1.50	
HCFU207-20	1-1/4											HC207-20	FU207	1.50	
HCFU207-21	1-5/16	4-9/16	3-5/8	53/64	43/64	1-3/8	35/64	2-3/32	2.012	0.740	7/16	HC207-21	FU207	1.50	
HCFU207-22	1-3/8											HC207-22	FU207	1.50	
HCFU207-23	1-7/16											HC207-23	FU207	1.50	
HCFU208	40	129	101.5	24	17	39	14	58.9	56.3	21.4	M12	HC208	FU208	1.95	
HCFU208-24	1-1/2	5-5/64	4	15/16	43/64	1-17/32	64/35	2-5/16	2.217	0.843	7/16	HC208-24	FU208	1.95	
HCFU208-25	1-9/16											HC208-25	FU208	1.95	
HCFU209	45	135	105	24	18	40	16	58.9	56.3	21.4	M14	HC209	FU209	2.27	
HCFU209-26	1-5/8											HC209-26	FU209	2.27	
HCFU209-27	1-11/16	5-5/16	4-9/64	15/16	23/32	1-37/64	5/8	2-5/16	2.217	0.843	1/2	HC209-27	FU209	2.27	
HCFU209-28	1-3/4											HC209-28	FU209	2.27	
HCFU210	50	143	111	28	20	45	18	66.1	62.7	24.6	M16	HC210	FU210	2.71	
HCFU210-29	1-13/16											HC210-29	FU210	2.71	
HCFU210-30	1-7/8	5-5/8	4-3/8	1-3/32	25/32	1-49/64	23/32	2-39/64	2.469	0.969	5/8	HC210-30	FU210	2.71	
HCFU210-31	1-15/16											HC210-31	FU210	2.71	
HCFU210-32	2											HC210-32	FU210	2.71	
HCFU211	55	162	130	31	21	49	18	74.6	55.6	22.2	M16	HC211	FU211	3.70	
HCFU211-32	2											HC211-32	FU211	3.70	
HCFU211-33	2-1/16	6-3/8	5-1/8	1-7/32	53/64	1-59/64	23/32	2-17/32	2.1890	0.874	5/8	HC211-33	FU211	3.70	
HCFU211-34	2-1/8											HC211-34	FU211	3.70	
HCFU211-35	2-3/16											HC211-35	FU211	3.70	
HCFU212	60	175	143	34	22	53.5	18	80.8	77.8	31	M16	HC212	FU212	4.59	
HCFU212-36	2-1/4											HC212-36	FU212	4.59	
HCFU212-37	2-5/16	6-37/64	5-5/8	1-11/32	55-64	1-7/64	23/32	3-3/16	3.063	1.220	5/8	HC212-37	FU212	4.59	
HCFU212-38	2-3/8											HC212-38	FU212	4.59	
HCFU212-39	2-7/16											HC212-39	FU212	4.59	
HCFU213	65	184	149	38	22	58	18	89.6	85.7	34.1	M16	HC213	FU213	5.99	
HCFU213-40	2-1/2	7-1/4	5-55/64	1-1/2	55/64	2-9/32	23/32	3-17/32	3.374	1.343	5/8	HC213-40	FU213	5.99	
HCFU213-41	2-9/12											HC213-41	FU213	5.99	
HCFU214	70	188	152	38	23	59	18	89.6	85.7	34.1	M16	HC214	FU214	6.39	
HCFU214-42	2-3/8											HC214-42	FU214	6.39	
HCFU214-43	2-11/16	7-13/32	5-63/64	1-1/2	29/32	2-21/64	23/32	3-17/32	3.374	1.343	5/8	HC214-43	FU214	6.39	
HCFU214-44	2-3/4											HC214-44	FU214	6.39	
HCFU215	75	200	159	41	24	62	18	95.8	92.1	37.3	M16	HC215	FU215	7.32	
HCFU215-45	2-13/16											HC215-45	FU215	7.32	
HCFU215-46	2-7/8	7-7/8	6-17/64	1-39/64	15/16	2-7/16	23/32	3-49/64	3.626	1.469	5/8	HC215-46	FU215	7.32	
HCFU215-47	2-15/16											HC215-47	FU215	7.32	
HCFU215-48	3											HC215-48	FU215	7.32	



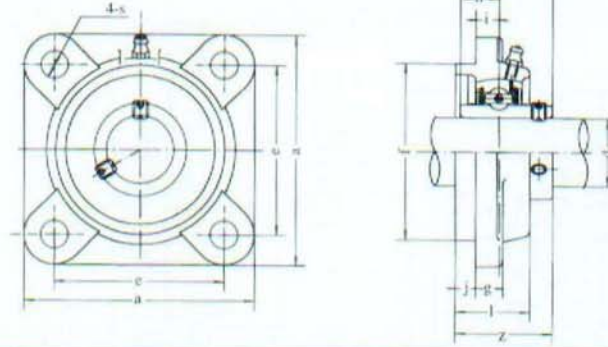

Unit No.	mm Dimensions												Bolt size mm inch	Bearing No.	Housing	Weight (kg)
	d	a	e	i	s	g	l	f	z	b	n	inch				
UCFS305	25	110	80	9	16	7	13	29	80	39	38	15	M14	UC305	FS305	1.3
UCFS305-13	13/16													UC305-13		
UCFS305-14	7/8	4 11/32	3 5/32	23/64	5/8	9/32	1/2	1 9/64	3.1496	1 17/32	1.4961	0.591	1/2	UC305-14		
UCFS305-15	15/16													UC305-15		
UCFS305-16	1													UC305-16		
UCFS306	30	125	95	10	16	8	15	32	90	44	43	17	M14	UC306	FS306	1.9
UCFS306-17	1 1/16													UC306-17		
UCFS306-18	1 1/8	4 29/32	3 47/64	25/64	5/8	5/16	19/32	1 17/64	3.5433	4 47/64	1.6929	0.669	1/2	UC306-18		
UCFS306-19	1 3/16													UC306-19		
UCFS307	35	135	100	11	19	9	16	36	100	49	48	19	M16	UC307	FS307	2.4
UCFS307-20	1 1/4													UC307-20		
UCFS307-21	1 5/16	5 5/16	3 15/16	7/16	3/4	23/64	5/8	1 13/32	3.9730	1 59/64	1.8898	0.748	5/8	UC307-21		
UCFS307-22	1 3/8													UC307-22		
UCFS307-23	1 7/16													UC307-23		
UCFS308	40	150	112	13	19	10	17	40	115	56	52	19	M16	UC308	FS308	3.3
UCFS308-24	1 1/2	5 29/32	4 13/32	33/64	3/4	25/64	21/32	1 9/16	4.5276	2 13/64	2.0472	0.748	5/8	UC308-24		
UCFS308-25	1 9/16													UC308-25		
UCFS309	45	160	125	14	19	11	18	44	125	60	57	22	M16	UC309		
UCFS309-26	1 5/8													UC309-26	FS309	4.0
UCFS309-27	1 11/16	6 5/16	4 59/64	35/64	3/4	7/16	23/32	1 47/64	4.9213	2 23/64	2.2441	0.866	5/8	UC309-27		
UCFS309-28	1 3/4													UC309-28		
UCFS310	50	175	132	16	23	12	19	48	140	67	61	22	M20	UC310		
UCFS310-29	1 13/16													UC310-29	FS310	5.3
UCFS310-30	1 7/8	6 7/8	5 13/64	5/8	29/32	15/32	3/4	1 57/64	5.5118	2 41/64	2.4016	0.866	3/4	UC310-30		
UCFS310-31	1 15/16													UC310-31		
UCFS311	55	185	140	17	23	13	20	52	150	71	66	25	M20	UC311	FS311	6.2
UCFS311-32	2													UC311-32		
UCFS311-33	2 1/16	7 9/32	5 33/64	43/64	29/32	33/64	25/32	2 3/64	5.9055	2 51/64	2.5984	0.984	3/4	UC311-33		
UCFS311-34	2 1/8													UC311-34		
UCFS311-35	2 3/16													UC311-35		
UCFS312	60	195	150	19	23	14	22	56	160	78	71	26	M20	UC312	FS312	7.2
UCFS312-36	2 1/4													UC312-36		
UCFS312-37	2 5/16	7 11/16	5 29/32	3/4	29/32	35/64	7/8	2 7/32	6.2922	3 5/64	2.7953	1.024	3/4	UC312-37		
UCFS312-38	2 3/8													UC312-38		
UCFS312-39	2 7/16													UC312-39		
UCFS313	65	208	166	15	23	18	22	58	175	78	75	30	M20	UC313	FS313	8.9
UCFS313-40	2 1/2	8 3/16	6 17/32	19/32	29/32	45/64	55/64	2 9/32	8.8898	3 5/64	2.9528	1.181	3/4	UC313-40		
UCFS313-41	2 9/16													UC313-41		
UCFS314	70	226	178	18	25	18	25	61	185	81	78	33	M22	UC314		
UCFS314-42	2 5/8													UC314-42	FS314	11
UCFS314-43	2 11/16	8 29/32	6 1/64	45/64	63/64	45/64	31/32	2 13/32	7.2635	3 3/16	3.0708	1.299	7/8	UC314-43		
UCFS314-44	2 3/4													UC314-44		
UCFS315	75	236	184	21	25	18	25	66	200	89	82	32	M22	UC315	FS315	13
UCFS315-45	2 13/16													UC315-45		
UCFS315-46	2 7/8	9 9/32	7 1/4	53/64	63/64	45/64	31/32	2 19/32	7.8740	3 1/2	3.2263	1.260	7/8	UC315-46		
UCFS315-47	2 15/16													UC315-47		
UCFS315-48	3													UC315-48		
UCFS316	80	250	196	18	31	20	27	68	210	90	86	34	M27	UC316	FS316	15
UCFS316-49	3 1/16													UC316-49		
UCFS316-50	3 1/8	9 27/32	7 23/32	45/64	1 7/32	25/32	1 1/16	2 63/64	8.2677	3 35/64	3.3858	1.339	1	UC316-50		
UCFS316-51	3 3/16													UC316-51		
UCFS317	85	260	204	24	31	20	27	74	220	100	96	40	M27	UC317	FS317	17
UCFS317-52	3 1/4													UC317-52		
UCFS317-53	3 5/16	10 1/4	8 1/32	15/16	1 7/32	25/32	1 1/16	2 29/32	8.6814	3 15/16	9.7795	1.575	1	UC317-53		
UCFS317-54	3 7/16													UC317-54		
UCFS317-55	3 7/16													UC317-55		
UCFS318	90	280	216	24	35	20	30	76	240	100	96	40	M30	UC318	FS318	21
UCFS318-55	3 7/16	11 1/32	8 1/2	15/16	1 3/8	25/32	1 3/16	3	9.4488	3 15/64	3.7796	1.575	1 1/8	UC318-55		
UCFS318-56	3 1/2													UC318-56		
UCFS319	95	290	228	39	35	20	30	94	250	121	103	41	M30	UC319		
UCFS319-58	3 5/8													UC319-58	FS319	25
UCFS319-59	3 11/16	11 13/32	8 31/32	1 17/32	1 3/8	25/32	1 3/16	3 45/64	9.8425	4 49/64	4.0551	1.614	1 1/8	UC319-59		
UCFS319-60	3 3/4													UC319-60		
UCFS320	100	310	242	39	38	20	32	94	260	125	108	42	M33	UC320	FS320	30
UCFS320-61	3 13/16													UC320-61		
UCFS320-62	3 7/8	12 7/32	9 17/32	1 17/32	1 1/2	25/32	1 3/16	3 45/64	10.2362	4 59/64	4.2520	1.854	1 1/4	UC320-62		
UCFS320-63	3 15/16													UC320-63		
UCFS320-64	4													UC320-64		